

FLEX SPACE AVAILABLE

6 Union Hill Road
West Conshohocken, PA 19428



PROPERTY HIGHLIGHTS:

- Rental Rate: \$11.50 SF NNN (\$2.20)
- 13,000 SF, One-story flex building
- 13' clear
- Climate controlled
- Access to shared loading dock
- Excellent location in West Conshohocken
- Easy access to routes 76 & 476
- Potential signage (Can be seen from Rt. 476)

Available June 1st, 2023

FOR INFORMATION, CONTACT:

COLIN McHALE
cmchale@beaconcre.com

610.828.0100

No warranty or representation, expressed or implied, is made as to the accuracy of the information contained herein, and same is submitted subject to errors, omissions, change of price, rental or other conditions, withdrawal without notice, and to any special listing conditions, imposed by our principals.

6 UNION HILL ROAD, WEST CONSHOHOCKEN, PA

13,000 RSF

Unit A

6 Union Hill Rd. W. Conshohocken, PA 19428

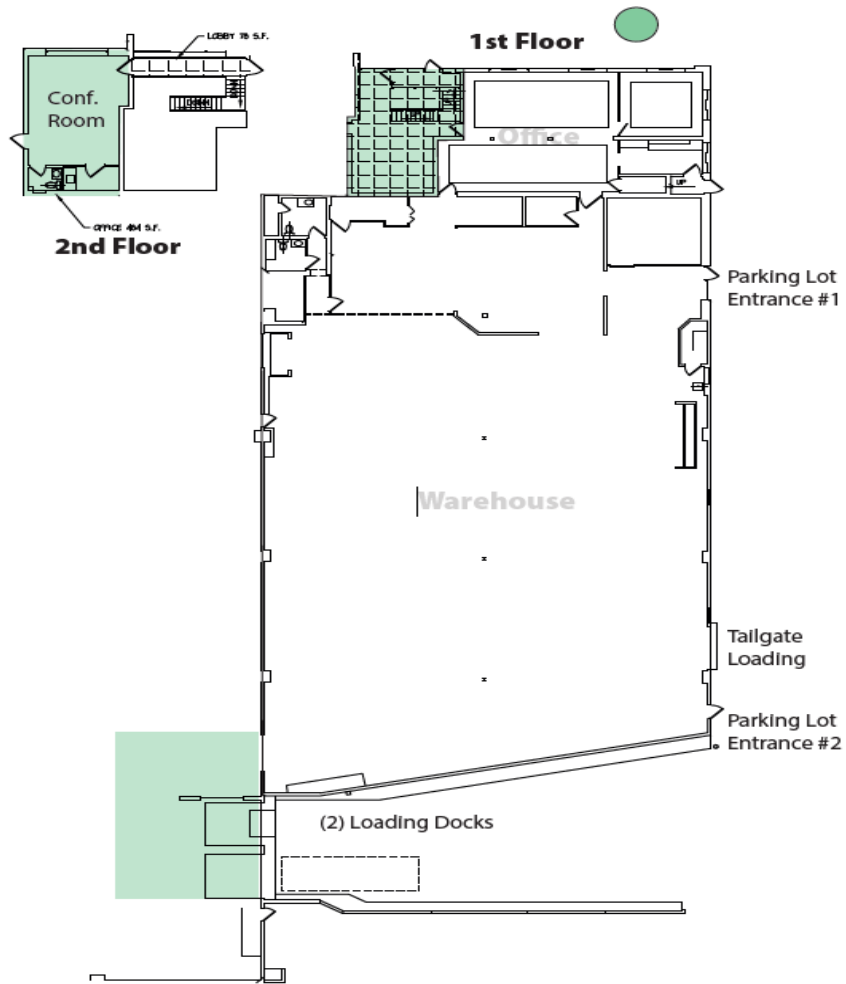

No warranty or representation, expressed or implied, is made as to the accuracy of the information contained herein, and same is submitted subject to errors, omissions, change of price, rental or other conditions, withdrawal without notice, and to any special listing conditions, imposed by our principals.

290 KING OF PRUSSIA ROAD, BUILDING 1, SUITE 200 • RADNOR, PA 19087

PHONE: 610.828.0100 • FAX: 610.828.3873

WWW.BEACONCRE.COM